

Dieseltriebwagen VT 89.9 (ex. VT 133) 2920

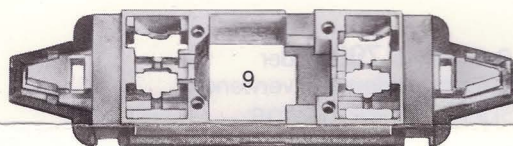

1 Gehäuse, komplett	2920-001
2 Vorbau	2920-3
3 Stoßstange	2920-9
4 Schraube	2065-25
5 Leiterplatte, komplett	2920-005
6 Motor, komplett	2920-020
7 Achshalter	2920-10
8 Stromabnehmer	2920-28
9 Fahrrahmen	2920-1
10 Radsatz, komplett	2920-010

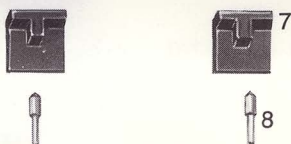
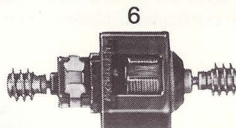
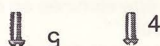
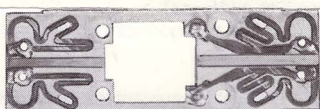
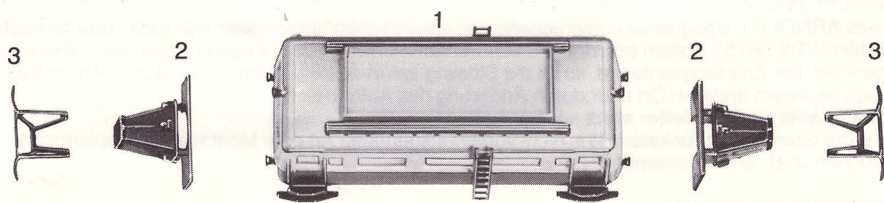

2920

VT 89.9

Order Nr.

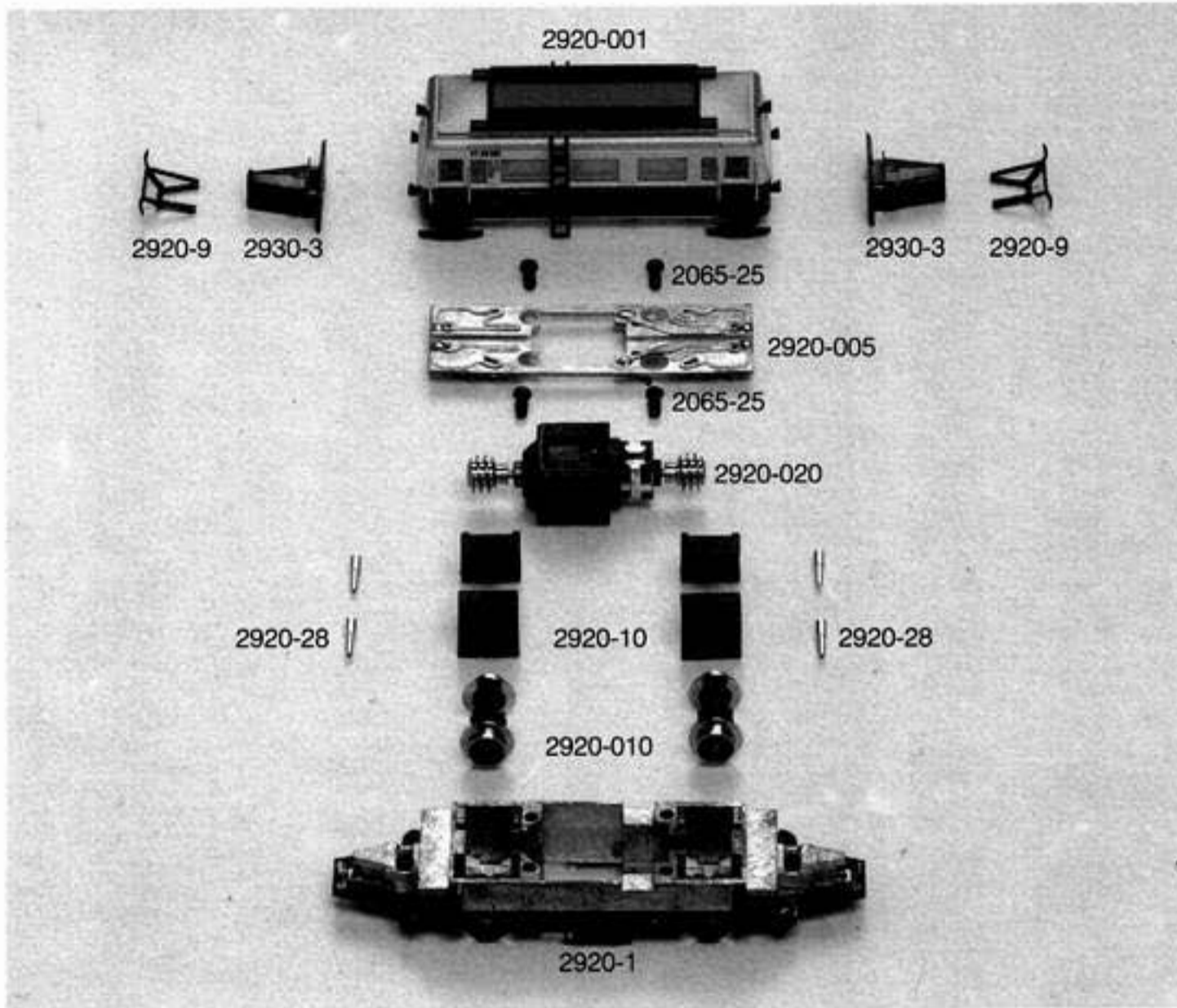

2920-001	Gehäuse komplett
2920-3	Vorbau
2920-9	Stoßstange
2065-25	Schraube
2920-005	Leiterplatte
2920-020	Motor
0101-26	Kohlebürsten
2215-75	Andruckfedern
2920-10	Achshalter
2920-28	Stromabnehmer
2920-010	Radsatz
2920-1	Fahrrahmen